

| | |
|----------------|----------------|
| Material 材質 | Hardness 硬度 |
| S136 | HRC48°~50° |

| Catalog N o. | | L | M |
|--------------|-----|------|------|
| Type | D | | |
| JH070 | 3.1 | 8.0 | M1.6 |
| | 4.4 | 10.0 | M2.3 |
| | 5.2 | 12.0 | M2.5 |
| | 6.2 | 14.0 | M3 |
| | 8.2 | 14.0 | M4 |

日期章鑲件:

此鑲件可調整更換,不需要拆卸,不會影響生產進度。

Use insert:

Due to fact that the insert adjustable/removable from the front of the mold there is no need to remove the tool from the machine or disassemble the mold.

注意事項/Notice:

如果需要更換鑲件,用螺絲起子將新的鑲件順時針旋入,聽到“卡喀”聲音,即完成。

If need replase the date component ,use a tool to rotate the new component in.

向模具裝入方法:

1. 安裝時請用(中空)銅類、軟質物體輕敲壓入。
2. 要確認安裝孔徑大小、孔徑深度是否正確。
3. 中心偷孔不能超過蓋子範圍,以防射出成型時下陷。
4. 確保工件成型美觀,安裝時請注意字體方向。
5. 安裝時遇到R面或斜面時可隨該斜面加工。

Install method:

1. Use copper or other soft material to knock when install it
2. Make sure the diameter and the depth of the hole right
3. The center hole can not exceed the range of the lid, to avoid sinking when ejecting.
4. Notice the character's direction to make sure the plastic products beautiful
5. can per the bevel to process when find R face or bevel when install it

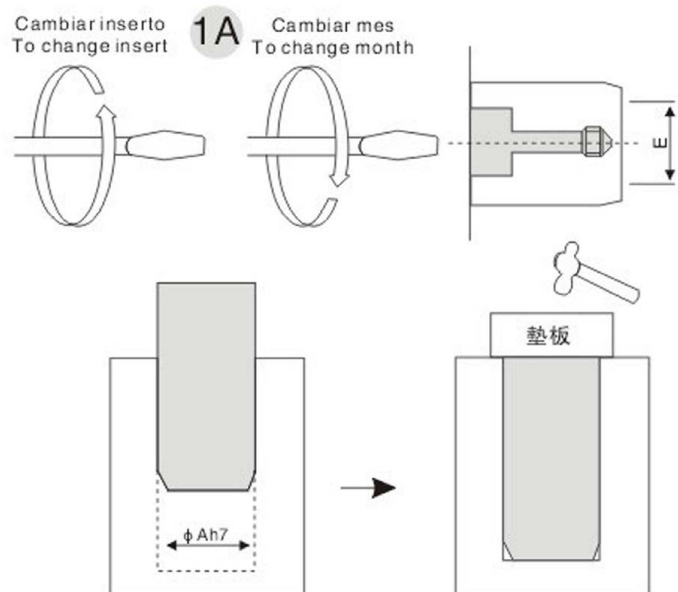

● Order: Catalog No. x 選購時,請注明欲标示的年份

備注: 圓面之外特殊規格可定制

2D下載

3D下載

返回索引