

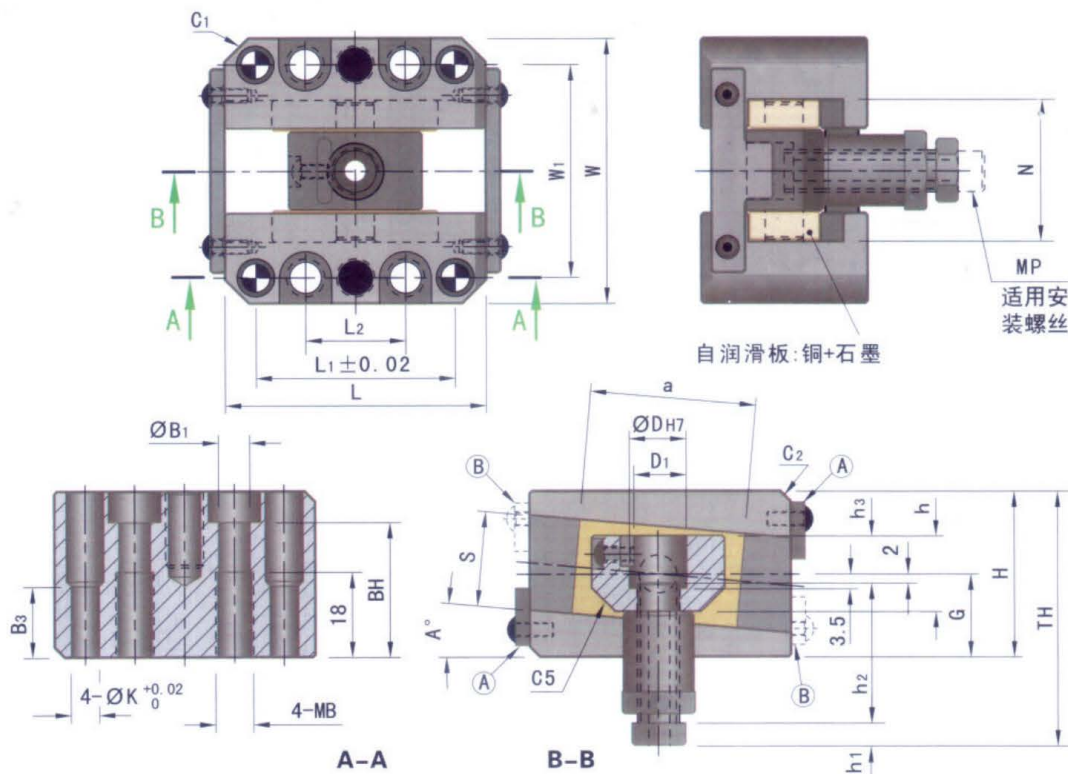

适用斜顶杆:

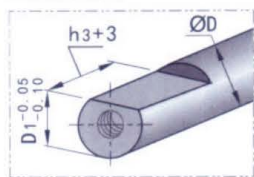

D	W	L	H	C1	C2	D1	d	h	h1	h2	h3	N	S	a	TH			
12	56	55	35	5	-	11	5.5	16	6	33	10	30	20	35	58.5			
16	60	65	36	15		9	18											
20	68	70	43	6	5	18	11	22	6	36	13	38	24	45	65.5			
25	75	80	45			22		26		39	15	45				26	45	69.5
30	81	95	54			27.5		30		41	17	51				30	55	70

Code	D	L1	L2	W1	B1	B3	BH	G	K	MB	MP	擋塊安裝位置		A°
												A	B	
SSCZA	12	42	21	45	6.6	15	28.5	17.5	6	M8	M5	0°-10°		0123
	16	46	25	48			29.5	18			M8			
	20	50		55	8.6	20	34.5	21.5	8	M10	M10	4°-10°	0°-3°	4567
	25	60	62	36.5			22.5							
	30	75	50	68			45.5	27						

安装示意图:

